

Staff **News 'n' Views**

St Helens and Knowsley Teaching Hospitals NHS Trust

Issue 26 February 2010



THE NEW WHISTON HOSPITAL OPENING SOON



Excellent Patient Care in World Class Hospitals

Kath Lawrenson



MBE

Kathleen Lawrenson, Audiologist at St Helens Hospital, has been honoured with an MBE for her services to healthcare.



L-R: Anne-Marie Stretch, Director of Human Resources, Jane Cook, Audiologist, The Mayor of St Helens Cllr Terry Shields, Jean Marsh, Audiologist, Kathleen Lawrenson MBE, Ann Marr, Chief Executive, Jacquie Connolly, Audiology Manager

Kathleen joined the Trust as a trainee in 1964 and at the age of just seventeen established the very first NHS hearing centre in St Helens. Over 5 years Kathleen developed the centre to become a full service including assessment, fitting and ongoing rehabilitation and support within the local community.

Kathleen was also instrumental in the development of the service at the new St Helens Hospital. Kathleen has been at the forefront of providing patients with the latest digital hearing aid technology to improve the quality of service they receive.

Speaking about her MBE Kathleen says: 'I am delighted, it is wonderful to be recognised in this way and I am looking forward to meeting the Queen. I am really honoured that my colleagues nominated me. 'It is fantastic to receive an MBE, but I will still be me.'

Ann Marr, Chief Executive said: "Congratulations to Kathleen on this most prestigious and sincerely deserved honour. Kathleen has served the Trust and the local community faithfully for many years and her dedication and commitment is to be applauded."



Employee of the Month



December 2009: Maria Stead

Productive Wards Facilitator, Nursing Directorate

Reason for Nomination:

Maria has been involved with the Productive Ward programme since it was established and plays a vital role in its continued success in creating more efficient wards where nurses have more time to dedicate to patient care. Maria is a passionate and enthusiastic champion for the programme. She is widely respected and actively works alongside staff on the ward to help identify improvements in efficiency.



January 2010: Gary Barker

Senior Health Advisor, Sexual Health Clinic

Reason for Nomination:

Gary has played a leading role in setting up the very first rapid HIV testing services in Merseyside. The service based at St Helens Hospital provides patients with their test results in 30 minutes helping to reduce their anxiety and giving them faster access to support services. Gary has helped improve the quality of care the Trust provides to patients and is always looking for new ways of improving the service.

To nominate one of your colleagues for 'Employee of the Month' go to the Staff Matters section of the Trust Intranet and fill out an online form. Alternatively contact Trish Caldwell on ext: 1250 or email: trish.caldwell@sthk.nhs.uk

Girls on Film!

The Truth About Tanning

Girls Aloud singer, Nicola Roberts visited the Trust to take part in a BBC documentary raising awareness of skin cancer and the dangers of using tanning salons.

The documentary, which was shown on BBC3 in February highlighted the dangers of sunbeds and their links to skin cancers such as melanomas.

Nicola, from Runcorn, presented the documentary which featured Dr Sandra Winhoven, Consultant Dermatologist and Sehwan Liew, Consultant Plastic Surgeon caring for their patients.



Girls Aloud star Nicola Roberts with patient Lynn Trueman



L-R Louise Anderson, Healthcare Assistant; Lesley Bragg, Nurse Specialist, Nicola Roberts, Singer, Dr Sandra Winhoven, Consultant Dermatologist and Chris Hunt, Dermatology Nurse Specialist.

The programme also included patient Lynn Trueman. It showed her discussing the risks of tanning with Nicola and undergoing treatment, Lynn said:

"I was happy to take part in the programme to highlight the dangers of sunbeds to young people. I have two young daughters and I wouldn't want them or any other youngsters to have to go through what I went through. The care I received by Mr Liew and his team was excellent."

Positive Report for Cancer Services

The National Peer Review Team recently assessed cancer services at the Trust and preliminary reports are extremely positive.

The team reviewed the Specialist Skin Service, Gynaecology and Urology teams and were very impressed with the work being carried out and the proactive work of the teams in providing patients with excellent care.

The team were especially pleased with the newly developed Regional Specialist Skin Service which combines the Trust's expertise in dermatology, cancer care, radiology and plastic surgery. This team meet regularly to review skin cancer cases at the Trust and also provides treatment for complex cases referred to the Trust by doctors from across Merseyside.

Ann Marr, Chief Executive said: "I would like to thank all members of the teams for achieving this positive review and for their continued efforts to keep the Trust at the forefront of providing cancer patients with excellent care."



Another Clean bill of health!

The Trust has again achieved all the requirements of an independent inspection into the prevention and control of infections.

The Trust was visited in January 2010 as part of an annual series of unannounced visits to hospitals throughout the country by the Care Quality Commission (CQC).

The inspectors visited the surgical assessment unit, the acute medical unit and ward H5 - stroke unit and found that the Trust met all the criteria.

Ann Marr, Chief Executive said: "I am delighted that we have met all of the requirements of the hygiene inspection again. Maintaining our excellent record in these inspections is a tribute to the hard work of our staff and illustrates our commitment to providing patients with an environment that is clean and safe."

The Trust is:

- ✓ Ensuring that the environment is clean and well maintained
- ✓ Providing adequate hand washing facilities and antibacterial hand rub
- ✓ Decontaminating instruments and equipment effectively
- ✓ Providing patients and the public with information on how the Trust is preventing and controlling infections
- ✓ Carrying out regular audits to ensure that policies are being followed

Getting better all the time!

A national survey of outpatient departments shows the Trust is providing an excellent standard of care.

The survey conducted by the Care Quality Commission asked patients about the care they received in outpatient clinics.

The results show:

- Over 90% of patients said they were treated with dignity and respect
- Over 85% of patients said they received excellent care
- More patients were given an appointment within a month of referral than the national average
- More patients said the outpatient department was very well organised
- Patients highlighted the cleanliness of clinics and facilities

The last national survey of outpatient departments was carried out in 2005 and since then the Trust has made significant improvements, with patients being given appointments faster, spending more time in consultation with doctors and receiving a higher standard of care in a cleaner environment.

TeamTalkLunch

Trust Board Members Les Howell, Chairman, Ann Marr, Chief Executive and David Bradbury, Non-Executive Director were joined by staff from various wards and departments throughout the Trust for a Team Talk lunch meeting.

These informal meetings provide an opportunity for staff and Board members to share their views and discuss ways to improve patient care.

Recent discussions included the following:

STAFF ASKED:	THE TRUST RESPONDED:
When are staff moving into the new Whiston Hospital and where are they moving to?	A 'What's Happening & When' timetable has been published and distributed to all wards and departments and is available on the staff intranet. See also pages 10 and 11 in this issue of News 'n' Views.
Will staff receive induction training for the new Whiston Hospital before moving in?	All staff will receive a formal induction and be given a tour of the new hospital. They will be shown a training DVD and will receive a staff booklet to help orientate them before moving in.
Why are the operating theatres not signposted in the new Whiston Hospital?	The signs in the new hospital have been designed to help patients and visitors find their way around the hospital. Operating theatres have restricted access and are therefore not included on the signs.
Why are orthopaedic staff to be relocated to different units?	Staff working in the Orthopaedic Unit need to work across all areas to gain the necessary skills.
Patients with vascular dementia need a wider variety of meal choices and menus with pictures	The Trust has a close partnership with Medirest and will work with them to ensure that these patients have a wider choice of meals with picture menus made available.



Les Howell, Chairman sharing his thoughts with members of staff



Ann Marr, Chief Executive in discussion with members of staff



David Bradbury, Non-Executive Director, listening to the views of staff members

The Doctor will see you now ...

Two new GP surgeries have opened at St Helens Hospital providing patients with increased access to a local doctor.

Located on Level 2 in the Orange Zone at St Helens Hospital, the two new practices are:



The Worshipful Mayor of St Helens Cllr Terry Shields opening the new GP surgery at St Helens Hospital

Sherdley Medical Centre

GP surgery opening times:

- Monday to Friday 8am – 8pm
- Saturday 8am – 12pm

The centre welcomes 3 new GPs to St Helens and includes 2 treatment rooms and 7 consulting rooms. The centre is managed by Aspect Health, a consortium of 4 local practices and provides a one stop shop for healthcare at St Helens Hospital.

Elder Care - Home Surgery Service

Providing services at home:

- Monday to Friday 8am – 8pm
- Saturday 8am – 12pm

This is an innovative practice where doctors and nurses provide care to elderly housebound patients in their own homes. This scheme has been running since April 2009 and the practice at the hospital will provide an administrative base.

The new centre was opened on 28th January 2010 by The Mayor of St Helens, Cllr Terry Shields.

New Dialysis Unit Welcomes First Patients



L-R: Patient John Kerrigan, Mike Yarwood, Healthcare Assistant, Elaine Carville, Ward Manager, Wayne Huxley, Staff Nurse and patient Alan Tickle at the new Dialysis Unit in St Helens Hospital.

The new Dialysis Unit at St Helens Hospital is now open and treating its first patients.

The newly built 12-bed unit is one of a number of new facilities opening across Cheshire and Merseyside as part of the government's independent sector procurement scheme.

The new unit, which will be formally opened on 8th March, is part of a wider

kidney care strategy aimed at increasing dialysis services and ensuring that patients with kidney problems have access to treatment as close to their homes as possible.

The unit is hosted by the Trust but is managed by independent sector company; Fresenius Medical Care Renal Services. Patients will be under the care of Consultant Nephrologists from the Royal Liverpool & Broadgreen University Hospitals NHS Trust.

Magnet arrives for new Whiston MRI scanner

The magnet for the new MRI scanner has been brought into the new Whiston Hospital as the building is being prepared for its grand opening.

The MRI scanner is one of the first of its type in this country and will be one of the hospitals most expensive new items of medical equipment. A huge crane was used to lift the six and a half tonne magnet (the weight of an Indian Elephant) into the building.



The big crane that lifted the magnet



Vinci construction staff used an electric transporter to guide the magnet through the new hospital

corridors and into the new Radiology Department.

David Anwyl, Assistant Director of Operations for Clinical Support Services said, "This state of the art MRI scanner will produce highly detailed images to further improve the quality of patient care."

The magnet being guided into the new Whiston Hospital

Whiston Hospital's Major Incident Exercise

The Trust is planning an emergency exercise at the new Whiston Hospital to test plans for a major incident.

The exercise, named '**Dark Matter**', will take place on Saturday 13th March and will involve nominated staff from the Trust along with colleagues in the emergency services, local authorities and voluntary agencies.

Exercise **Dark Matter** will enable agencies to practice their coordinated emergency response and test the Accident and Emergency team within the new Whiston Hospital. The exercise will also test lines of communication between those in charge of the emergency response and give staff practical experience of running a reception centre for family and friends of the casualties.

Jayne Heaney, Head of Emergency Planning said: "As a key organisation in response to a major emergency, the Trust is obliged to undertake a mock exercise every 3 years. Exercise **Dark Matter** will give us a one off opportunity to practice in an empty, Accident and Emergency Department so that we are fully prepared and have robust plans in the event of an actual major incident."



Introducing the Carers Support Team

The Carers Support team provide advice, support and information on a wide range of services for carers, including getting help with claiming benefits. This is an invaluable service for carers and staff at the Trust can refer people who are in need of assistance.

The service is a partnership between the Trust and its Halton and St Helens based partners in the Primary Care Trust, the local councils and the Princess Royal Trust for Carer's Centres.

The Carers Support team aim to improve NHS services for carers and develop best practice for hospital based support, right here at the Trust.

The team are available at the information point behind the main reception in St Helens, 8:30am to 4:30pm Monday to Thursday and 8:30 to 4pm on Friday. Alternatively call 01744 646 640 on weekdays from 8:30am to 8pm or visit the website at: www.nationalcarerdemonstratorsite.co.uk.



Meet the Team – L-R: Carer Support Workers Liz Bunting, Karen Grimshaw and Maureen Austin, Receptionist Sue Kerr, Jenny Ackers, Income Maximisation Officer and Anthea Smith, Senior Carer Support Worker

Patient Data - **PROTECTED!**

Maintaining patient confidentiality is paramount to the Trust's commitment to the privacy and dignity of patients. In support of this, over 170 administration staff recently were given intensive training on the Data Protection Act (1998).

The 16 week course is aimed at raising awareness of various requirements of the act and to remind staff of the ongoing need to protect patient information.

Craig Walker, Information Governance & Freedom of Information Officer, who led the course says:

"This refresher course is aimed at all staff involved in handling and processing patient records such as ward clerks, receptionists and other administration staff. The course highlights the Trust's commitment to protecting patient information to ensure that patients are provided with the utmost privacy and dignity."



Craig Walker, (centre) Information Governance & Freedom of Information Officer with ward clerks from Maternity, Burns & Plastic Surgery and Surgical Care displaying their certificates



THE NEW WHISTON HOSPITAL OPENING SOON

The new Whiston Hospital is almost complete, marking the final stages of an exciting redevelopment project to transform both Whiston and St Helens hospitals into world class hospitals with state of the art facilities and the very best services for patients.



An aerial photograph of the new Whiston Hospital



Lifts on the Central Corridor

We will be moving from out-dated Victorian buildings into one centralised six floor building. The hospital will provide the full range of acute healthcare services with new modern wards and departments, over 800 beds with 50% of patients cared for in single room accommodation with en-suite facilities and 1,500 car parking spaces including the multi-storey car park.

Over the next few pages you can see the floor plans for the new Whiston Hospital, illustrating the new locations of wards and departments. You will also see a



A Nurse Base on the Lower Ground Level

list of what is happening and when, outlining when and where departments and wards will be transferred into the new hospital.



Single-room with en-suite, where 50% of patients will be cared for



One of the new operating theatres

What's Happening & When



This information is correct at the time of print but due to the scale of the project, this information may be subject to change (January 2010).

DATE	WARD / DEPARTMENT	NEW LOCATION	LEVEL	COLOUR
Sat 6th March	Executive Offices	Executive Offices	5	Blue
Mon 8th March	Multi-faith Centre	The Sanctuary	1	Yellow
Mon 8th March	Main Reception	Information Desk	1	Yellow
Mon 8th March	K Block Offices	Surgical Care Offices	4	Orange
Mon 8th March	Hulme Ward (surplus St Helens beds)	Ward 3A (Trauma and Orthopaedics)	3	Green
Tue 9th March	Rowan House Admin Offices	Various	2	Purple
Tue 9th March	Rowan House Admin Offices	Various	3	Orange
Tue 9th March	Social Services	Social Services	3	Green
Fri 12th March	Pharmacy - Offices	Pharmacy	1	Yellow
Fri 12th March	Outpatient Department - Radiology	Outpatients and Blood Tests	1	Yellow
Sat 13th March	Outpatient Department	Outpatients and Blood Tests	1	Yellow
Sat 13th March	Outpatient Department - Phlebotomy	Outpatients and Blood Tests	1	Yellow
Sat 13th March	Ambulance Liaison	Ambulance Liaison	1	Yellow
Sat 13th March	Paediatric Outpatient Department (Rowan House)	Children and Young Peoples Outpatient Department	2	Purple
Sat 13th March	General Office	General Office	1	Yellow
Sat 13th March	Ward A1 (Urology) - Cystoscopy equipment	Ward 4A (General Surgery)	4	Orange
Sun 14th March	Pharmacy - Dispensary & Stores	Pharmacy	1	Yellow
Mon 15th March	EBME/Equipment Pool	EBME/Equipment Pool	5	Blue
Mon 15th March	Paediatric Dental (Cedar Suite)	Children and Young Peoples Outpatient Department	2	Purple
Mon 15th March	Paediatric Offices	Outpatients and Blood Tests	1	Yellow
Mon 15th March	Therapy Department	Therapy Suite	1	Yellow
Mon 15th March	Dietetic Department	Therapy Suite	1	Yellow
Wed 17th March	Cardio Respiratory	Cardio Respiratory (ECG)	1	Yellow
Wed 17th March	Neurophysiology	Neurophysiology	1	Yellow
Thu 18th March	PALS	PALS	1	Yellow
Thu 18th March	Undergraduate Services	Rowan House	1	Yellow
Fri 19th March	Birch House	Rowan House	2	Yellow
Fri 19th March	On Call Rooms	On Call Accommodation	2	Purple
Fri 19th March	Relatives Accommodation	Relatives Accommodation	2	Purple
Fri 19th March	Relatives Accommodation	Relatives Accommodation	3	Green
Fri 19th March	Radiology - Main X-Ray & Nuclear Medicine	Radiology (X-Ray, MRI, CT Scan, Ultrasound)	LG	Red
Fri 19th March	Plastics Pre-Op (Gynaecology ward)	Rowan House	LG	Red
Sun 21st March	Endoscopy	Endoscopy Suite	1	Yellow
Mon 22nd March	Ward K5 (Cardiology)	Ward 1D (Cardiology)	1	Yellow
Mon 22nd March	Ward K7 (Cardiology)	Ward 1D (Cardiology)	1	Yellow
Tue 23rd March	Ward H5 (Stroke Rehabilitation)	Ward 1A (Acute Stroke Unit)	1	Purple
Tue 23rd March	Therapy Suite	Entrance to Ward 1A, 1B, 1C	2	Orange
Tue 23rd March	Therapy Suite	Entrance to Ward 2A, 2B, 2C	2	Orange
Wed 24th March	Theatres - Emergency, Trauma, Elective	Theatres	4	Orange
Wed 24th March	Anaesthetic Administration	Anaesthetics Offices	4	Orange
Wed 24th March	Critical Care	Ward 4E (Critical Care Unit)	4	Orange
Wed 24th March	Coronary Care Unit	Ward 1E (Coronary Care Unit)	1	Yellow
Wed 24th March	HSDU Receipt and Distribution Centre	HSDU Receipt and Distribution Centre	LG	Red
Thu 25th March 8am	Accident and Emergency Department	Accident and Emergency Department	LG	Red
Thu 25th March	Observation Ward	Observation Ward	LG	Red
Thu 25th March	Accident and Emergency Department Radiology	Radiology	LG	Red
Thu 25th March	AMU (Ward G8)	Ward 1C (Acute Medical Unit)	1	Yellow
Thu 25th March	GAU (Ward G7)	Ward 1B (Acute Medical Unit)	1	Yellow
Thu 25th March	SAU (Ward G7)	Ward 4B (General Surgery)	4	Orange
Thu 25th March	Ward G3 (Orthopaedics)	Ward 3C (Trauma and Orthopaedics)	3	Green
Thu 25th March	Trauma and Orthopaedics - Plastics Therapy Room	Ward 3B (Trauma and Orthopaedics)	3	Green
Thu 25th March	Trauma and Orthopaedics Store	Ward 3B (Trauma and Orthopaedics)	3	Green
Thu 25th March	Trauma and Orthopaedics - Plaster Room	Ward 3C (Trauma and Orthopaedics)	3	Green
Thu 25th March	Theatres - ENT, Emergency, Orthopaedic, TH 11, TH 12	Theatres	4	Orange

DATE	WARD / DEPARTMENT	NEW LOCATION	LEVEL	COLOUR
Fri 26th March	Ward E1 (Paediatrics)	Ward 4F (Children and Young Peoples)	4	Orange
Fri 26th March	Ward E2 (Paediatrics)	Ward 3F (Children and Young Peoples)	3	Green
Fri 26th March	Ward G2 (Trauma)	Ward 3B (Trauma and Orthopaedics)	3	Green
Fri 26th March	Medical Photography	Medical Photography	3	Green
Fri 26th March	Discharge Lounge/Operational Services	Operational Services	1	Yellow
Fri 26th March	Ward K3 (Care of the Elderly) - interim	Ward H5 (Stroke Rehabilitation) - interim	4	Orange
Sat 27th March	Ward D2 (General Surgery)	Ward 4B (General Surgery)	4	Orange
Sat 27th March	Ward D1 (ENT/Urology)	Ward 4A (General Surgery)	4	Orange
Sat 27th March	Surgical Therapy	Entrance to Ward 4B (General Surgery)	4	Orange
Sat 27th March	Ward G1 (Regional Burns Unit)	Ward 4D (Regional Burns Unit)	4	Orange
Sat 27th March	Ward D3 (General Surgery)	Ward 4C (General Surgery)	4	Orange
Sun 28th March	Burns Theatre	Theatres	4	Orange
Tue 30th March	Hulme Ward (Surgical)	Ward 3Alpha (Trauma and Orthopaedics)	3	Green
Tue 30th March	Burns and Plastics Administration	Burns and Plastics Offices	3	Green
Tue 30th March	G5 (Haematology Ward)	Ward 2A (Haematology and Oncology)	2	Purple
Tue 30th March	Plastics Consultant Psychologist Office	Entrance to Ward 3A (Plastics)	3	Green
Fri 2nd April	Ward G4 (Plastics Trauma)	Ward 3A (Plastics)	3	Green
Fri 2nd April	Ward G5D (Plastics Trauma)	Ward 3Alpha (Trauma and Orthopaedics)	3	Green
Fri 2nd April	Plastics Theatres	Theatres	4	Orange
Sat 3rd April	Holbrook Unit and Theatre	Holbrook Unit	3	Green
Sat 3rd April	Dressings Clinic	Burns Dressing Clinic	3	Green
Sat 3rd April	Prosthetics Unit	Prosthetics	3	Green
Sat 3rd April	Ward C1 (Respiratory)	Ward 2B, 2C (Respiratory)	2	Purple
Sat 3rd April	Ward G16 (Respiratory)	Ward 2C (Respiratory)	2	Purple
Sat 3rd April	Ward F2 (Female Respiratory)	Ward 2B (Respiratory)	2	Purple
Sat 3rd April	Ward C3 (General Medicine)	Ward 2D (General Medicine)	2	Purple
Sat 3rd April	Ward B2 (General Medicine)	Ward 1B (Acute Medical Unit)	1	Yellow
Sat 3rd April	Medical Records	Medical Records	1	Yellow
Sun 4th April	Ward B1 (Gastroenterology)	Ward 3D (Gastroenterology)	3	Green
Sun 4th April	Ward E3 (Gastroenterology)	Ward 3D (Gastroenterology)	3	Green
Sun 4th April	Ward C2 (Gastroenterology)	Ward 3D (Gastroenterology)	3	Green
Tue 6th April	Radiology - remainder	Radiology	LG	Red
Wed 7th April	Aseptic Suite	Aseptic Suite	1	Yellow
Thu 8th April	Maternity Offices	Medical Care Offices	2	Purple
Fri 9th April	Ward H4 (Gynaecology Ward)	Ward 3E (Gynaecology Suite)	3	Green
Fri 9th April	Gynaecology Pre-Op	Gynaecology Pre-operative Clinic	3	Green
Fri 9th April	BEP Clinic	BEP Clinic	3	Green
Fri 9th April	Maternity Theatre (Emergency)	Women's Theatres	2	Purple
Sat 10th April	Maternity Ultrasound	Women's Outpatient Suite	2	Purple
Sat 10th April	Delivery Suite	Delivery Suite	2	Purple
Sat 10th April	Ward H2 and Ward H1 (Ante/Post natal wards)	Ward 2E (Women's Ward)	2	Purple
Sat 10th April	Special Care Baby Unit (SCBU)	Special Care Baby Unit (SCBU)	2	Purple
Sun 11th April	FMAU	Women's Outpatient Suite	2	Purple
Sun 11th April	Women's Therapy and Parentcraft	Women's Outpatient Suite	2	Purple
Sun 11th April	Maternity Outpatients Department	Women's Outpatient Suite	2	Purple
Sun 11th April	Maternity Theatre	Women's Theatres	2	Purple
Mon 12th April	Ward G10 (Pathology)	Rowan House	2	Purple
Thu 15th April	Healthcare Library	Rowan House	LG	Red
Mon 26th April	Medical Therapy, ADL, Wards	Ward 5A and 5D (Department of Medicine for Older People)	5	Blue
Mon 26th April	Ward H3 (Care of the Elderly)	Ward 5A (Department of Medicine for Older People)	5	Blue
Mon 26th April	Ward G12 (Care of the Elderly)	Ward 5A,B,D (Department of Medicine for Older People)	5	Blue
Mon 26th April	Ward F3 (Care of the Elderly)	Ward 5D (Department of Medicine for Older People)	5	Blue
Mon 26th April	Ward F1 (Care of the Elderly)	Ward 5B (Department of Medicine for Older People)	5	Blue
Mon 26th April	Ward H5 (Formerly K3)	Ward 5C (Department of Medicine for Older People)	5	Blue

Lower Ground Red Floor

- 1 Radiology (X-Ray, MRI, CT Scan, Ultrasound)
- 2 Stores
- 3 Radiology Offices
- 4 Security Office
- 5 Observation Ward
- 6 Accident and Emergency
- 7 Facilities Management

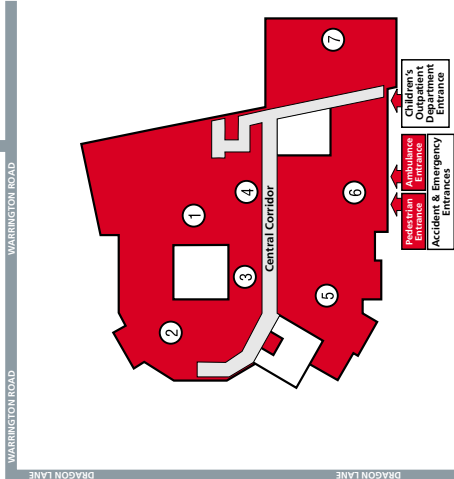

WARRINGTON ROAD

DRAGON LANE

Level 1 Yellow Floor

- 1A Ward 1A (Acute Stroke Unit)
- 1B Ward 1B (Acute Medical Unit)
- 1C Ward 1C (Acute Medical Unit)
- 1D Ward 1D (Cardiology)
- 1E Ward 1E (Coronary Care Unit)
- 2 Cardio Diagnostic Centre
- 3 Neurophysiology
- 4 Pharmacy
- 5 Medical Records
- 6 General Office
- 7 The Sanctuary
- 8 Cardio Respiratory (ECG)
- 9 Endoscopy Suite
- 10 Outpatients and Blood Tests
- 11 Operational Services
- 12 Ambulance Liaison
- 13 PALS
- 14 Shops
- 15 Therapy Suite

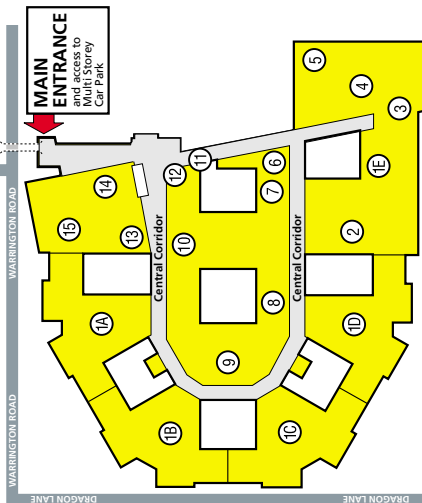

WARRINGTON ROAD

DRAGON LANE

Level 2 Purple Floor

- 2A Ward 2A (Haematology and Oncology)
- 2B Ward 2B (Respiratory)
- 2C Ward 2C (Respiratory)
- 2D Ward 2D (General Medicine)
- 2E Ward 2E (Women's Ward)
- 3 Children's and Young People's Outpatient Department
- 4 Medical Care Offices
- 5 Delivery Suite
- 6 Women's Theatres
- 7 Relatives Accommodation
- 8 Obstetrics Offices
- 9 Special Care Baby Unit (SCBU)
- 10 On Call Accommodation
- 11 Women's Outpatient Suite

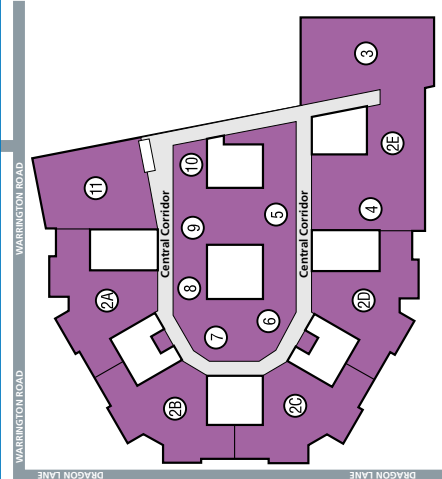

WARRINGTON ROAD

DRAGON LANE

Level 3 Green Floor

- 3 ALPHA Ward 3 ALPHA (Trauma and Orthopaedics)
- 3A Ward 3A (Plastics)
- 3B Ward 3B (Trauma and Orthopaedics)
- 3C Ward 3C (Trauma and Orthopaedics)
- 3D Ward 3D (Gastroenterology)
- 3E Ward 3E (Gynaecology Suite)
- 3F Ward 3F (Children & Young People)
- 4 Gynaecology Pre-Operative Clinic
- 5 BEP Clinic
- 6 Relatives Accommodation
- 7 Medical Care Offices
- 8 Plastic Surgery Offices
- 9 Holbrook Unit
- 10 Burns Dressing Clinic
- 11 Prosthetics
- 12 Medical Photography

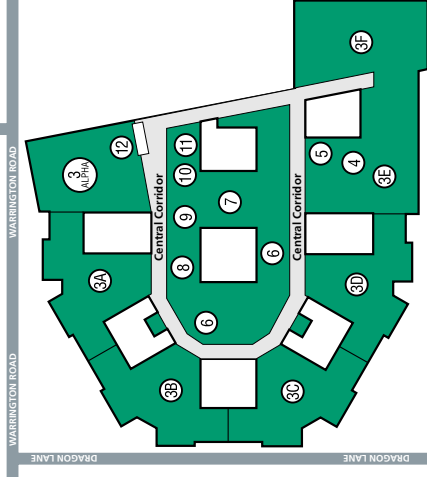

WARRINGTON ROAD

DRAGON LANE

Level 4 Orange Floor

- 4A Ward 4A (General Surgery)
- 4B Ward 4B (General Surgery)
- 4C Ward 4C (General Surgery)
- 4D Ward 4D (Regional Burns Unit)
- 4E Ward 4E (Critical Care Unit)
- 4F Ward 4F (Children & Young People)
- 5 Operating Theatres
- 6 Anaesthetics Offices
- 7 Surgical Care Offices

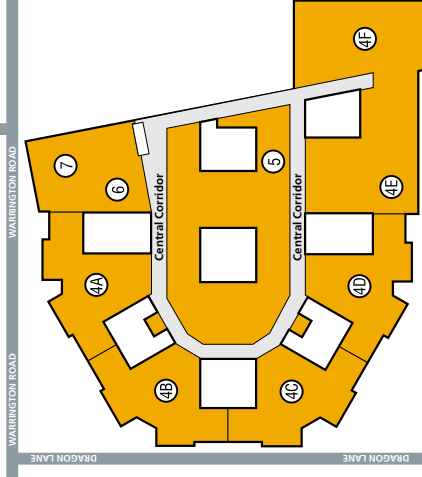

WARRINGTON ROAD

DRAGON LANE

Level 5 Blue Floor

- 5A Ward 5A (Department of Medicine for Older People)
- 5B Ward 5B (Department of Medicine for Older People)
- 5C Ward 5C (Department of Medicine for Older People)
- 5D Ward 5D (Department of Medicine for Older People)
- 6 Cold Decontamination
- 7 EBME/Equipment Pool
- 8 Executive Offices
- 9 Boardroom Suite
- 10 Restaurant

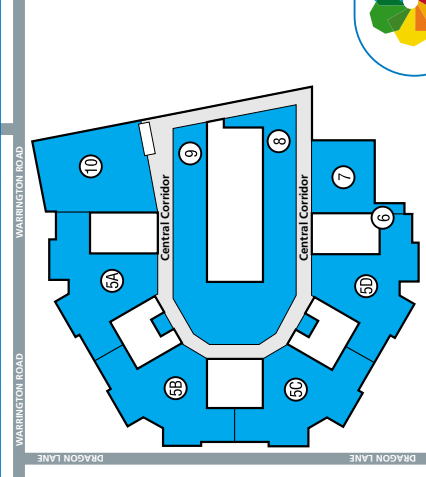

WARRINGTON ROAD

DRAGON LANE



**THE NEW
WHISTON HOSPITAL
OPENING SOON**

The Whiston Story



Medical House Officers and Nurses in 1913

The original Whiston Hospital was built in 1843 as a Victorian workhouse for the poor. By 1851 the workhouse accommodated 124 people including 7 employees. The first actual hospital wards were built in 1865 accommodating 50 male and 50 female patients and included a convalescent ward and an ophthalmic ward.

In 1871 a new General Hospital was built with a medical isolation unit added in 1887 for cases of cholera and other serious infectious diseases of the time. When the National Health Service was established in 1948, the hospital, then known as the County Hospital, had 6 main blocks of wards accommodating 500 patients.



An aerial photograph of the old General Hospital



Ward E3 in 1948

Renamed Whiston Hospital in 1953, the hospital expanded its range of specialties. In 1960 the 82 bed Burns & Plastic Surgery Unit opened and four years later a new Intensive Care Unit and a Pathology Laboratory were built. In 1973 these were joined by a new Maternity Unit, a Special Care Baby Unit, an Ear Nose and Throat Unit and the Postgraduate Medical Centre.

From 2010, the new Whiston Hospital will usher in a new era for both the Trust and the local community, with state of the art facilities in a new modern world class hospital.

Historic excerpts taken from 'A History of Prescott Union Workhouse', by Pauline Hurst, a fascinating new book outlining the story of the old Whiston Hospital. To purchase a copy for just £10 contact Pauline on: 07835 985 005 or paulinej.hurst@sky.com



Pauline Hurst with her new book

New Whiston Hospital Open Week

Monday 8th March to Friday 12th March

The Trust will be holding an open week at the new Whiston Hospital.

During this week the Trust will be inviting GPs from across the region, local MPs, healthcare partners and local people along with dignitaries and VIPs from the local area. The Trust will also be welcoming back retired staff who have played a key role in the development of the hospital.

For further information on the open week contact Judith Marsland on ext: 2505 or email judith.marsland@sthk.nhs.uk.



Trust nurses advise on RCN guidelines

Two children's nurses at Whiston Hospital have contributed to new Royal College of Nursing (RCN) guidelines on breast feeding.

Kate Walker and Stacey Moore, Breast Feeding Link Nurses, were selected to provide expert views to help mothers breast feeding their children while they are being cared for on children's wards.

Kate Walker said, "We work closely with our colleagues in maternity and found that having Link Nurses who are trained in breast feeding helps the new mums whose children are cared for on this ward to breast feed their children."

Stacey Moore said, "We based the recommendations on our experience and were keen to get involved in this project as we are dedicated to supporting breast feeding mums."

Their recommendations included:

- ✓ **New methods and equipment needed for expressing milk.**
- ✓ **Providing comfortable and private areas to express milk.**
- ✓ **Outlining the benefits of a balanced diet when breast feeding.**
- ✓ **Showing mothers alternative methods of feeding.**
- ✓ **Teaching mothers how to feed the baby breast milk through a tube.**

The RCN have now published the guidelines with Stacey and Kate included in the acknowledgments list. For the full document visit www.rcn.org.uk



Stacey Moore and Kate Walker, Breast Feeding Link Nurses with the new RCN guidelines

Last Class for Jean

Midwife Jean Blair gave her last parent education class after 30 years of teaching parenting skills to thousands of new parents in the area.

Although Jean has not retired and will continue to work as a Midwife at the Trust, she has 'passed the baton' to Nikki Sands, Midwife, who will now take the classes at Whiston Hospital.



L-R: Sandra Donnelly, Healthcare Assistant, parent Sarah Jane Jarman with baby Rebecca, Jean Blair, Midwife, parent Sonia Williamson with baby Caitlin, Val Blakemore, Matron.

Over the years, Jean says she has seen more and more couples attending classes and that in many cases she has taught two generations of the same

family! Jean said she had enjoyed teaching the classes and for her it was 'the end of an era'.

Angela wins it for the Trust

Congratulations to Angela Fitzgerald-Smith who was voted NHS Employee of the Month for November on the NHS247 website, after topping a nationwide vote of NHS workers.



Winner Angela Fitzgerald-Smith

Angela, a Colorectal Nurse Specialist based at Whiston Hospital, stands out from the crowd with her skill, enthusiasm and quality of care.

Angela said: "Providing patients with a high standard of care, makes me feel very privileged. It is extremely rewarding knowing that we can make a real difference to peoples' lives. It is something I have dedicated a great part of my life to."

NHS 247 has rewarded Angela with a weekend break for two at the magnificent Eastwell Manor 4 star hotel in Kent.



STAFF BRAVE THE

Staff at the Trust went to extraordinary lengths to brave the icy conditions in order to provide essential, life saving services and minimise disruption to patients.



Despite school closures and widespread transport chaos due to icy roads, staff at Whiston and St Helens hospitals managed to maintain as normal a service as possible by going the extra mile to get into work.

Many staff made the journey on foot, walking for up to two hours to make it into work, whilst others had to dig out cars stuck in snow and help other stranded colleagues along the way.

When the weather was at its worst some staff slept on camp beds at

the hospital overnight, so that they could be available for early morning shifts.

Maintenance staff worked around the clock to ensure car parks and public pathways were kept safe for both patients and staff. Around sixty tonnes of grit was used and a small army of staff battled against the ice and snow to clear pathways at both St Helens and Whiston hospitals.



Blow-up camp beds were made available for staff



Snow ploughs clear the way for patients and staff

WINTER WEATHER!



Diana Lewis, Senior HR Manager (centre back row), Joan Hardie, Working Family Advisor (far left), and Penny Keegan, Creche Matron (second from left) along with Creche staff who helped provide extra places for childcare

The Crèche provided extra places and extended its services to offer an 'Out of School Club' to help those whose children could not attend school because it had closed due to the bad weather.

Ann Marr, Chief Executive of the Trust, had these words of thanks for staff:

"I appreciate all of your heroic efforts in ensuring that we maintained high quality care to our patients and I am proud that I have such dedicated staff who are prepared to go the extra mile when the need arises."



Maintenance staff cleared roads and pathways to the hospital



A snowy St Helens Hospital entrance



The new Whiston Hospital - in a snow storm!



L-R: Sarah Parkar, Joanne Brown and Joann Reason, sNOW problem for these Cardiology Nurses!

Thank you to Dr Kevin Hardy, Director of Clinical Strategy for photographs of St Helens Hospital and the new Whiston Hospital in the snow.

Fantastic donation from the Burns Unit supporters

**SAVE OUR
BURNS
UNITS**



Ann Marr, Chief Executive with Eddie O'Hara MP and members of the Burns Unit Steering Group and the Burns Unit team as Cllr Denise Allen, Mayor of Whiston and the Mayor's consort Matthew Allen present the cheque for £1,200.

Burns Unit campaigners have given an amazing £1,200 to the Mersey Regional Burns Unit at Whiston Hospital, following the successful fight to keep local burns services.

The group received generous donations from members of the public to support the campaign to keep the burns units at Whiston Hospital and Alder Hey Children's Hospital.

After helping to fight off proposals to move services to Manchester, the group decided to give the money raised to the unit.

Ann Marr, Chief Executive said:

"This is a

fantastic donation and the Trust would like to thank the campaigners and all the people who gave their money to support our unit. This money will help us to provide burns patients from around across the region with world class care."

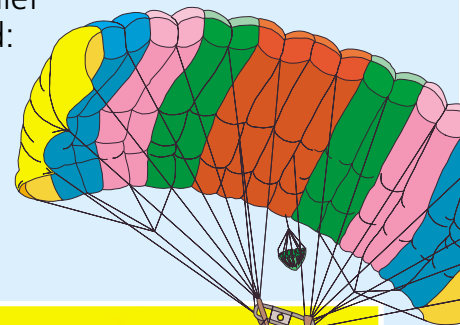

Mike Hulme, in red, gives the thumbs up as he freefalls

Skydive For SCBU

The Trust would like to thank Mike Hulme, from St Helens, for his sponsored skydive in aid of the Special Care Baby Unit at Whiston Hospital.

Mike's brave leap of faith raised over £1,500 after he skydived from 12,000ft above the ground, where he freefell at around 120mph before his parachute deployed.

A number of Mike's family members have been cared for by the Trust, which spurred on his decision to raise money for this worthy cause.

On his decision to do the skydive, Mike said: "It's something I've always wanted to do, so I thought it might as well be for a good cause, which the Special Care Baby Unit at Whiston certainly is."

Paul Stevenson - Fundraising Champion



A huge thank you to Paul Stevenson, receptionist at the Cardiology Clinic at St Helens Hospital for his fundraising work.

Paul organised a fundraising evening and the proceeds; an amazing £1,370 have been donated to the Lilac Centre at St Helens Hospital. This fantastic donation is hugely appreciated by the Trust.

The event in Rainhill Labour Club included a disco, live music and games including bingo and a raffle. Paul even took to the microphone himself to perform to an audience of over 200 people.

Paul organised the event himself in his own time because he wants to help the hospital and give people a night to remember. He said: "It wasn't a hardship because I really enjoyed doing it. I can't wait for the next one."

His next event is in May, once again at Rainhill Labour Club, and will this time benefit the Special Care Baby Unit at Whiston Hospital. Tickets will be available from Paul soon!



Paul Stevenson, Receptionist with Barbara Jost, Lilac Centre Manager and members of the Lilac Centre team

Kilimanjaro Conquered in Aid of The Lilac Centre

A big thank you to Paul Winders who climbed Tanzania's Mount Kilimanjaro, the tallest mountain in Africa, to raise £1,800 for the Lilac Centre at St Helens Hospital.

Last year Paul embarked on his trek to the top of the 19,340ft dormant volcano, completing a punishing hike of more than 80 kilometres, and reaching the summit at dawn.

Paul's mother, who was terminally ill with cancer, was cared for at the Lilac Centre.

Paul said: "My Mum often talked about the how caring the staff were. She said that they had always made her feel special. I wanted to raise funds in appreciation of the professionalism of the staff at this impressive facility and to help the centre care for others."

The extra money will go towards making patients as comfortable as possible while they receive their treatment at the Lilac Centre.



Paul (left) stands above the clouds in Tanzania with fellow climber, Richard Winrow.

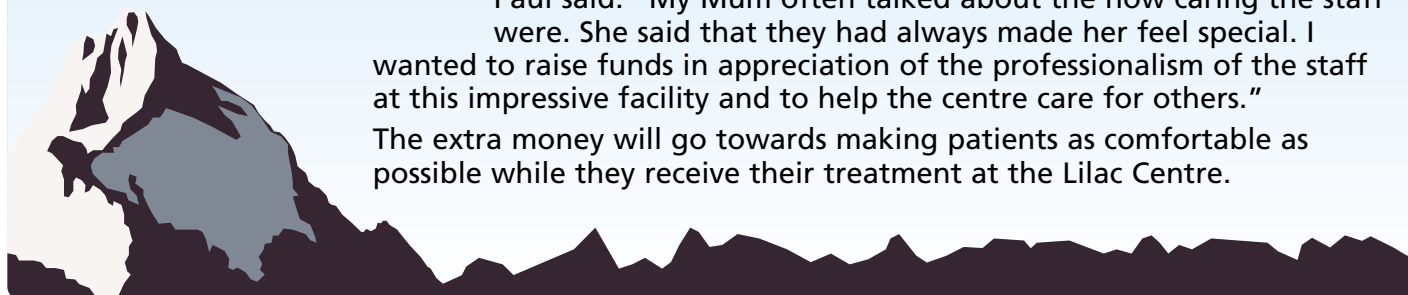



Fab 5 Save Lives in Ghana

Members of the Trust's maternity team have given their own time to help save the lives of mothers and new born babies in Ghana by training midwives and local people.

In Ghana, half of all babies are delivered by people without official medical training.

Based just outside Accra, the capital of Ghana, the team of 2 midwives and 3 doctors taught local health workers simple techniques for delivering a child safely using the Trust's 'Drills and Skills' plan.



The team L-R: Dr Nuala Quinn, Bev Hunt, Midwifery Sister, Charles Breeze, retired Obstetric Consultant Anaesthetist, Julie Sanderson, Midwife, Julie Langton, Consultant Obstetrician

Julie Langton, Consultant Obstetrician, said: "Our aim was to provide people with simple life-saving skills and if we've saved one baby or one mother, we've achieved our objective."

The team plan to return to Ghana in November 2010 to continue their work. They have organised a fundraising ball on the 12th March at Park Inn, St Helens. Tickets priced at £35 are available, for details contact Julie Langton on ext: 2354.



Ghanian midwives in training with a model baby

Saints

go marchin' in

St Helens Rugby League Football Club stars including Keiron Cunningham, Leon Pryce and Kyle Eastmond recently visited children being cared for on wards E1 and E2 in Whiston Hospital.

Players and coaching staff posed for pictures with the young patients and handed out Saints goody bags.



L-R: Head Coach Mick Potter, player Kyle Eastmond, Dr Laweh Amegavie, player Keiron Cunningham, Assistant Coach Keiron Purtill

Dr Laweh Amegavie, Clinical Director, said: "I would like to thank the Saints players and staff for taking time out of their busy schedule to come and see the children in our care. The visit really made their day and gave the staff a deserved boost too."





TRUST LOTTERY RESULTS

The recent Trust lottery winners are:

December 2009

- £1,500 Joan Morrison, Audiology, St Helens
- £500 Jean Macklin, Ear Nose and Throat Secretaries, St Helens
- £100 Georgina SurrIDGE, Theatres, St Helens
- £50 Jillian Atherton, Cancer Services, Whiston
- £25 Lillian Whittingham, Ward K5 Whiston
- £25 Carol Warwick, Patient Advice and Liaison Service, Whiston.

January 2010

- £1,500 Joanne Greenhalgh, Ward H1, Whiston
- £500 Janet Cuthbert, Acute Stroke Unit, Whiston
- £100 Jane Vedmore, Pathology, Whiston
- £50 Sheila Evans, Maternity Theatres, Whiston
- £25 Linda Farrow, Critical Care unit, Whiston
- £25 Colette Hunt, Human Resources, Whiston

Note: Prizes can only be issued to lottery participants who have paid all due contributions. In the case of deductions not being made from your pay, please contact the Finance Department on extension 1121. Your payslip should show a separate deduction described as LOTTERY and the amount deducted (£1 for each number).



Fond farewells ...



Dr Steve Atherton

Steve has worked at the Trust for 33 years, as a physician specialising in respiratory and intensive care as Unit Manager and Medical Director. He was instrumental in establishing one of the country's first Intensive Care Units and is widely respected by his colleagues at the Trust.

Ann Marr, Chief Executive said: "Steve has been a pioneer and a role model for clinical leadership. The Trust and the local community owe him a huge debt of gratitude for his role in developing our healthcare services."



Dr Steve Atherton with colleagues from the Acute Medical Unit



Caption: Dr Ian Gordon with colleagues from Occupational Health and Human Resources.

Dr Ian Gordon

Ian joined the Trust in 1979 and has worked in the Occupational Health Department for the last 18 years. He has treated staff from across the Trust and will be much-missed by his colleagues.

Ian says he has greatly enjoyed his work at the Trust and will fondly remember his colleagues and all those whom he has helped. In his retirement, Ian intends to find more time to learn to play the clarinet.

It's all an **illusion!**

Is the Centurian guarding an arch or 3 columns?



<http://www.indianchild.com>

Can you see two deer?



Did you know?



- 2000** - The much feared 'millennium bug' failed to bring computer systems crashing to a halt.
- 2001** - On 7th June Tony Blair's Labour Party won the General Election.
- 2002** - This year was the century's only year that reads the same forwards and backwards. The next one will be in 2112.
- 2003** - Hollywood actor Arnold Schwarzenegger became Governor of California.
- 2004** - On 4th February the popular social media website Facebook was founded at Cambridge, Massachusetstts.
- 2005** - On 2nd July the Live8 concert aimed to make poverty history.
- 2006** - Met Office say this is England's warmest year since records began in 1659, with an average temperature of 10.82 degrees celcius.
- 2007** - The final book of the Harry Potter series, Harry Potter and the Deathly Hallows, became the fastest-selling book in history with over 11 million copies bought in the first 24 hours on sale.
- 2008** - Liverpool was named European Capital of Culture.
- 2009** - The King of Pop, Michael Jackson died on June 25th.

IT Operations Help Desk
(0151) 676 5678
ithelpdesk@sthk.nhs.uk

Switchboard 0
Security, Fire, Emergency 3333
Cardiac Arrest 2222

Carers Support Team – (01744) 646 640

Local Security Management
Specialist (0151 430 1611)
Hospital Pager 1372

Facilities Management Helpdesk 1188

Staff **News 'n' Views**

Next Issue: April 2010

Many thanks to everyone who has been involved in producing this edition.

If you would like to contribute, please contact Judith Marsland, Head of Media, PR and Communications on 0151 430 2505 or judith.marsland@sthk.nhs.uk

The deadline for submitting items for the next News 'n' Views is:

17th March